

Dial Type Series

Model: DS-SB Public



Temperature Range	05-35 °C
Mounting Type	Flush
Set Back Function	Y
Digital Display	N
Time Clock Override Switch	Y
Dial Lock (using internal pins)	Y
Built In Sensor	Y
Remote Air Sensing Mode	Y
Floor Sensing Mode	N
Remote Probe Included	N
Built In Air & Floor	N
Adjustable Switching Differential	N
Accuracy	+/- 1.5°C

Supply	230VAC
Rating	3A
Installed Dimensions (L,H,D)	86 x 86 x 19mm
Weight	165g

Mode Table

The DS-SB Public has two different operating modes depending on the factory fitted link:

MODE	DESCRIPTION
Constant	The DS-SB Public is factory fitted with a link between the L & Ⓞ terminal. The thermostat will maintain the temperature set on the dial whilst this link is fitted (constant mode). The DS-SB Public offers a setback function that automatically reduces the set temperature by 4°C. To make use of the set back function, remove the factory fitted link between L & Ⓞ on the back of the DS-SB Public. When the thermostat receives a 230v signal on the Ⓞ terminal, the temperature will control to the setting on the dial. When there is no voltage on the Ⓞ terminal, the thermostat will operate in setback mode and automatically reduce the set temperature by 4°C.
Set Back	

Product Dimensions (mm) & Wiring Specification

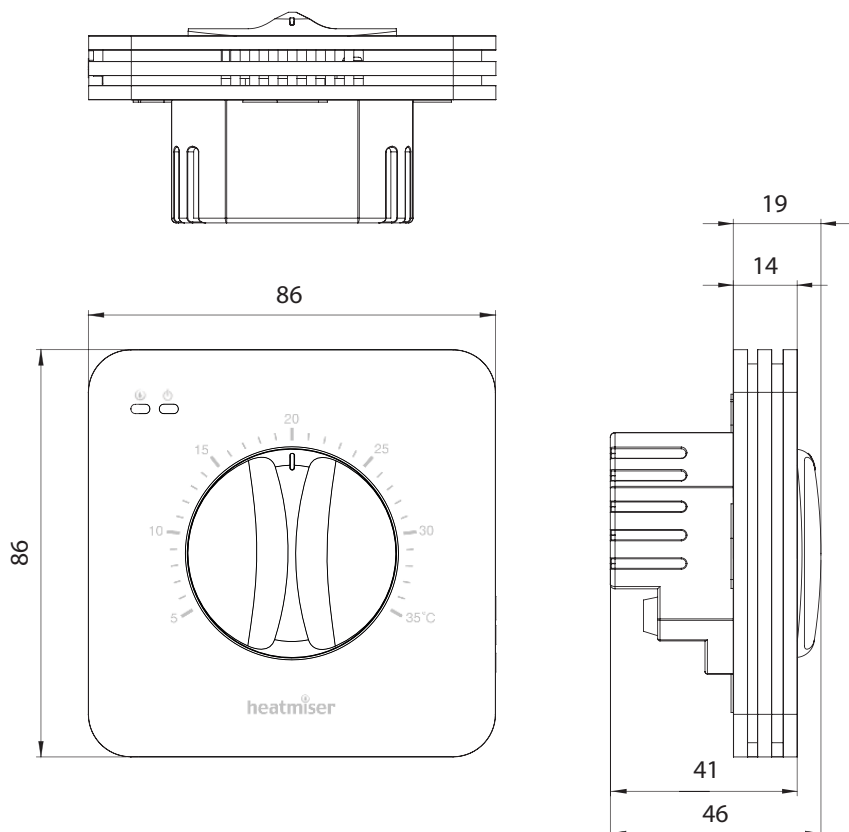

Model: DS-SB Public

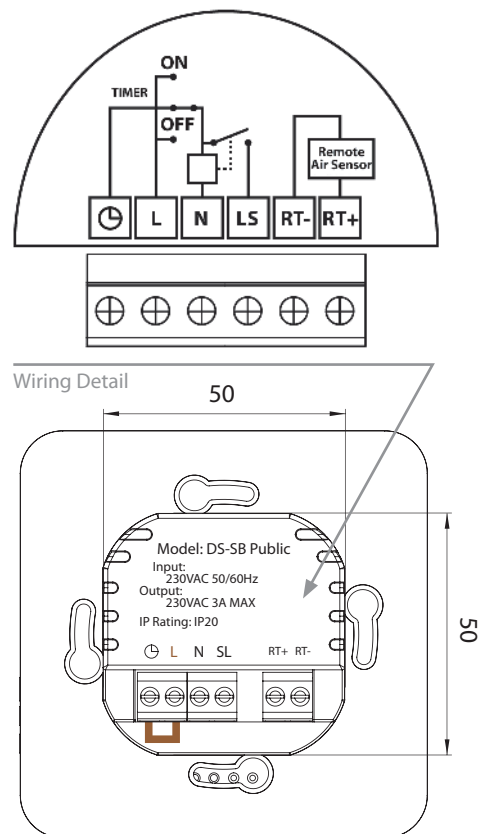

*Remove link between Ⓞ and L for setback mode.