

Description

A pre-routed, cement-coated XPS panel, designed for use with water-based underfloor heating systems. These overlay panels are made from high-density XPS (300 kPa), which is thermally insulating, lightweight, waterproof, and faced with a reinforced cement coating. The panels offer a quick and easy solution for the placement of pipework in both domestic and commercial underfloor heating applications. The lightweight, reinforced cement facing provides a robust surface that is ideal for direct bonding of tiles. Many other types of finish, such as engineered wood, carpet, vinyl, etc., can also be used with additional preparation of the panels.

These panels are ideal for installation on solid floors, such as concrete, screed, and asphalt floors, as well as suspended timber floors that have been boarded with suitable floor boarding, such as tongue-and-groove planking or chipboard planking. The panels are easy to cut and install and should be laid with the panel joints staggered in a brick bond style. The routed channels are compatible with most flexible low-pressure underfloor heating pipes. The panels are designed for use over existing floors, providing a low-height build-up and insulated floor.

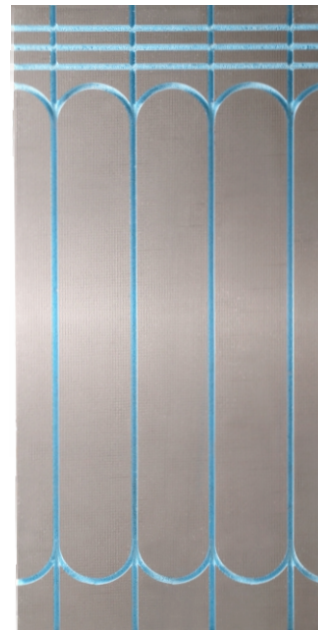

Product Code	Description
ZL-CPS300-16	300Kpa Board for 16mm Pipe

Technical Data

Performance	ZL-CPS300-16
Extruded Polystyrene-XPS	High Strength UFH Board
Strength at 10% compression	300 kpa
Thermal conductivity	0.033 W/mK
Temperature range	-50 / +75 °C
Density (foam core only)	33 kg/m ³
Pipe centres	150 mm
Board Size	600 x 1200 x 20 (mm)
Fire-retardant class	Europe E Class
Thickness/weight	20mm/2.6kg
Sound Reduction	20dB
Water Absorption by volume tested to BSEN 12087	0.8%
Output at 50°C	80 W/m ²
Recommended Flow Temp	45°C to 55°C

Dimension

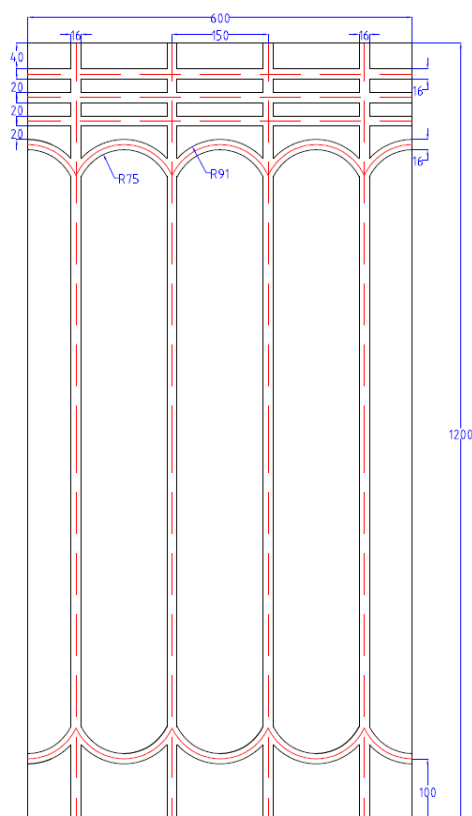

■ INSTALLATION

These Cement Boards allow for quick installation over a flat, level subfloor. They can also be applied over various other substrates, provided they are fully supported and, where necessary, used in conjunction with a damp-proof membrane (DPM).

■ TIMBER BASE

When installing on timber surfaces, the panels should always be secured with mechanical fixings and washers. The fixings must be of an appropriate length for the specific application.

■ CONCRETE BASE

For installations directly onto concrete, the boards should be adhered using a layer of combed tile adhesive (S1 or equivalent). In some cases, mechanical fixings may also be required depending on the substrate.

■ FINISHING

In most situations, no additional board is needed, and flooring can be laid directly on the upper surface.

Wood flooring should be installed using a suitable underlay as per the manufacturer's instructions. Flooring-grade tiles can be applied using a suitable combed tile adhesive layer.

For other types of finishes, a separating layer of Construction Board may be needed before proceeding with the installation.

■ SUITABLE FOR

The Cement Board is suitable for both new construction and retrofit installations.